





# HT 400 TIMBER-ALUMINIUM ENTRANCE DOOR



|   |                           |   |
|---|---------------------------|---|
|  | <b>Thermal insulation</b> | $U_D$ as low as 0.67 W/(m <sup>2</sup> K) |
|  | <b>Noise reduction</b>    | up to 34 dB                               |
|  | <b>Security</b>           | up to RC2                                 |
|  | <b>Locking</b>            | Multi-point locking                       |
|  | <b>Construction depth</b> | 85 mm                                     |



Square edge on inside and outside



Timber/Foam Insulation/Aluminium composite for maximum thermal performance

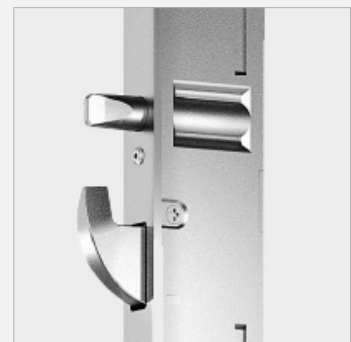

5-lever locking as standard for highest security

# HT 400

## Diagram

Section - bottom

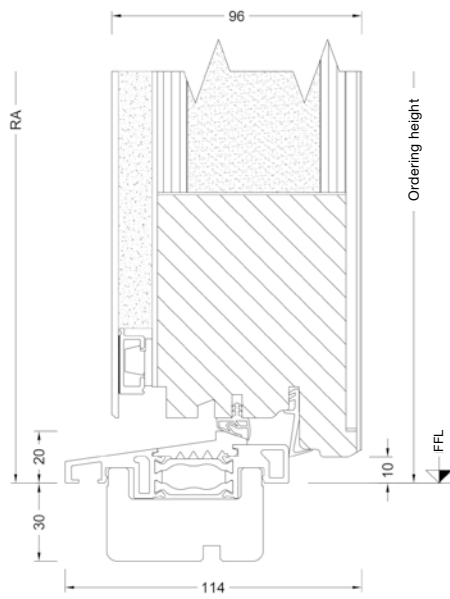

Side section - top

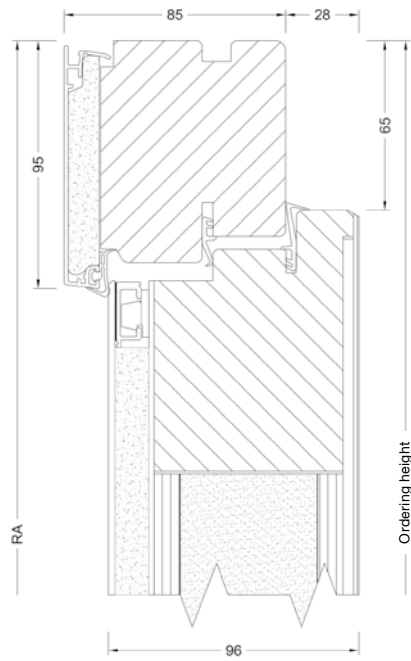

DR



PE



AG



PS

Further entrance door options can be found in the Door Designer:



### Internorm by InterHaus

Unit 17, 217 Speers rd., Oakville,  
ON L6K 2E8

Tel.: +1 437 770 1512

Email: [info@interhaus.ca](mailto:info@interhaus.ca)