

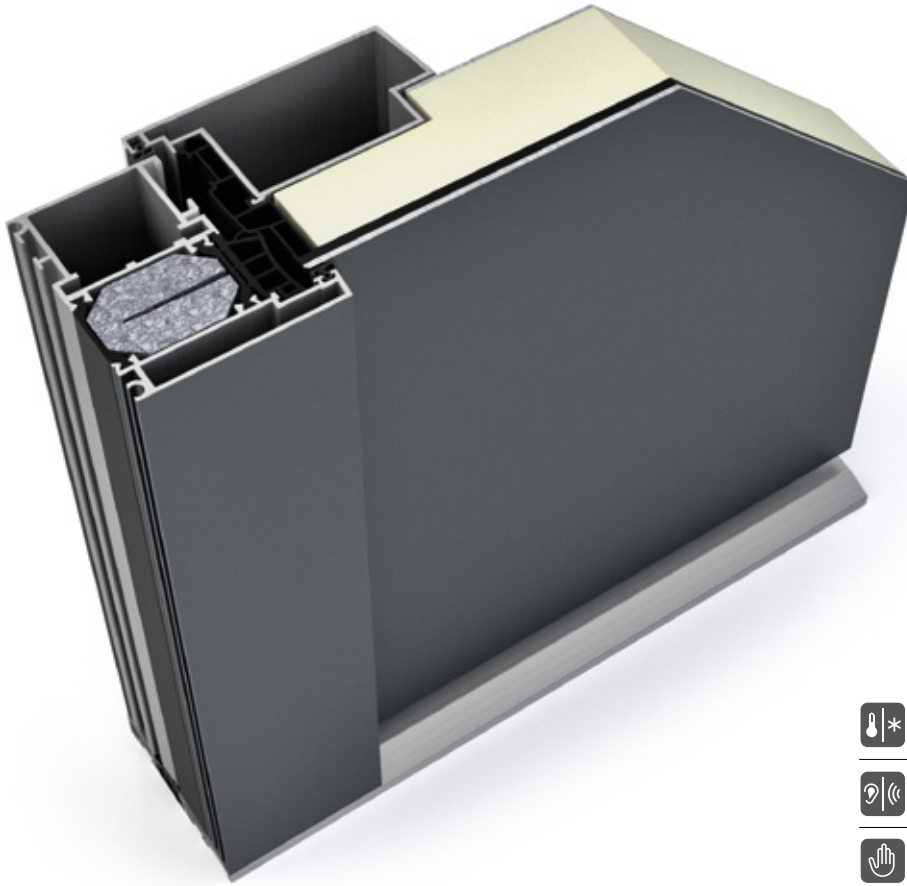





# AT 520 ALUMINIUM ENTRANCE DOOR



	<b>Thermal insulation</b>	$U_D$ as low as 0.80 W/(m <sup>2</sup> K)
	<b>Noise reduction</b>	up to 32 dB
	<b>Security</b>	up to RC2
	<b>Locking</b>	Multi-point locking
	<b>Construction depth</b>	93 mm

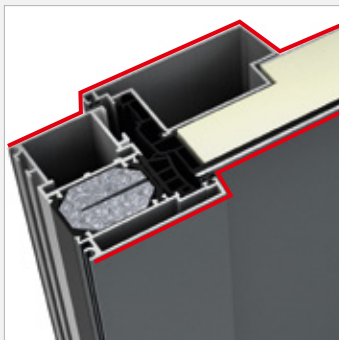

Round edge on inside,  
square edge on outside

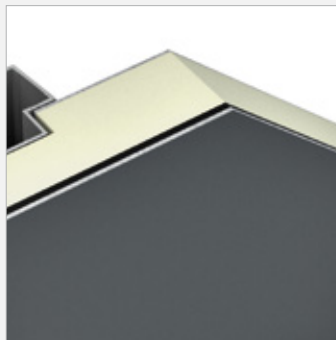

Cavity-filled structure with  
expansion insert for thermal  
stability

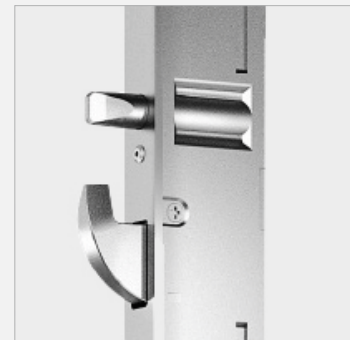

5-lever locking as standard for  
highest security

# ALUMINIUM ENTRANCE DOOR

## AT 520

### Diagram

Section - bottom

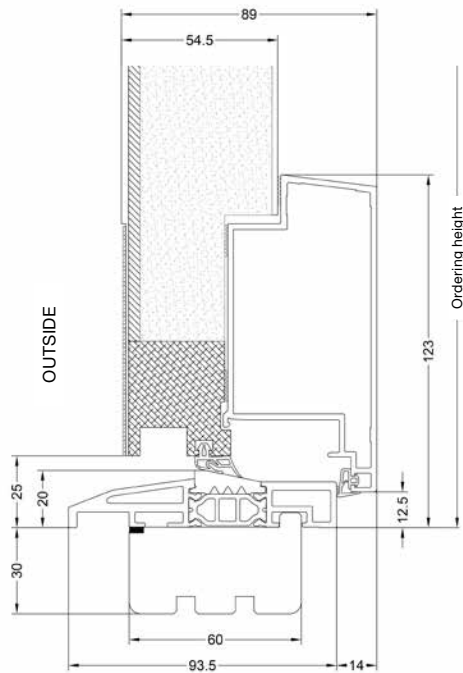

Side section - top

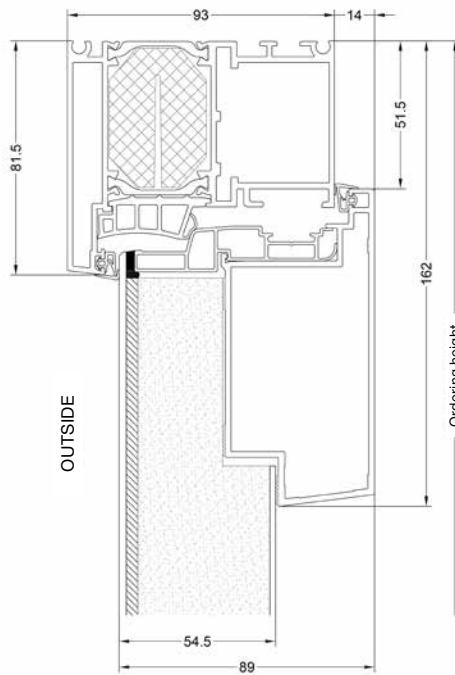

**SA**  
Order No: S0001



**SG**  
Order No: S0003



**AD**  
Order No: A0002



**SP**  
Order No: S0007

Further entrance door options can be found in the Door Designer:



### Internorm by InterHaus

Unit 17, 217 Speers rd., Oakville,  
ON L6K 2E8

Tel.: +1 437 770 1512

Email: [info@interhaus.ca](mailto:info@interhaus.ca)

3/2020

[www.interhaus.ca](http://www.interhaus.ca)